

TYPICAL REMOTE CONSOLE

ARMED Light (red): When lit, the burglary system is armed in one of its protective modes. When not lit, burglary protection is disarmed.

POWER Light (green): When lit, AC mains power is being provided to the system. Not lit indicates that AC mains power has been interrupted (the system will continue to operate for some time, using its rechargeable back-up battery). See "Power Failure Indications" on page 8.

BUILT-IN INTERNAL SOUNDER: A built-in sounder provides warning and confirmation sounds for the system.

CONSOLE DISPLAY AREA: An LCD (Liquid Crystal Display) indicates the status of the system at all times and also displays the nature and location of all abnormal occurrences.

KEYPAD: A 12-key digital keypad is used to enter all system commands, initiate emergency alarms, etc.

MODES OF OPERATION

DISARMING (when the ARMED light is on)

Disarming is accomplished by entering your 4-digit user code, then pressing the OFF key. Your keypad beeps once to indicate that the system is disarmed. *You must disarm the system within the entry delay period when entering through the entry/exit delay door (the keypad will beep slowly, reminding you to disarm the system), or an alarm will occur.*

Security System

User's Manual

4110DLa/4110XMPa

ADEMCO

INTRODUCTION

Congratulations, you have selected one of the finest alarm systems available for your protection. Your installer has custom programmed system features to meet your specific requirements.

This alarm system was designed for high reliability, excellent security and simplicity of operation. These features make it easy for you to get the most out of your system and prevent false alarms.

GENERAL DESCRIPTION

This security system can protect your premises with zones of protection containing a variety of sensors.

Alarms can be automatically initiated from the sensors or manually initiated from the console's keypad.

The console displays system status and accepts user commands. Multiple consoles can be used in your system. Each console contains 12 key buttons, a Liquid Crystal Display (LCD) for status and zone numbers, ARMED and POWER lights, and a warning sounder (see next page).

Zones displayed can be controllable (burglary) or 24-hour protection zones (fire, emergency, etc.). Controllable zones can be turned on and off (armed and disarmed) from the keypad by means of a personal four-digit master security code known only to you and yours (programmed at the time of installation) or up to six temporary secondary user codes that may be assigned and/or changed by you at any time, as described later.

If "Quick Arming" was enabled at the time of installation, the # key can be pressed in lieu of the four-digit code, when arming.

If you have chosen to be notified of alarms or other system conditions by pager, the following codes will be sent to your pager by the control:

1811 = Trouble	1911 = Alarm
1001 = Open	1002 = Close

DELAY ZONE ENTRY AND EXIT TIMES

Your system is programmed by the installer with preset time delays, which allow you to leave and reenter through the entry/exit delay door without setting off an alarm. When you enter, the system must be disarmed during the entry delay period or an alarm will occur. The entry delay feature may be turned off for greater security when you are sleeping or while you are away for extended periods of time (INSTANT or MAXIMUM modes, described later). Record your delay times here:

EXIT DELAY: _____ sec

ENTRY DELAY: _____ sec.

READY Key: Before your system can be armed in any of the following modes, all protected doors, windows and other protection points not on the normal exit route must be closed (or bypassed...see **BYPASSING ZONES** on next page). If the words **NOT READY** appear, press the **READY [T]** key to display the numbers of the zones not intact, so that appropriate action can be taken for zones not on the exit route.

AWAY ARMING (when leaving with entry/exit delay on)

To arm all your system's protection (interior and perimeter) and leave, enter your user code and press the **AWAY [2]** key. The keypad will beep twice and **AWAY** will be displayed. *You must leave through the entry/exit delay door within the exit delay period. After that, opening the delay door will initiate the entry delay period and the system must then be disarmed to avoid an alarm.*

Note: Any zones on the exit route not initially closed must be closed by the end of the exit delay period, or they will be bypassed at that time.

STAY ARMING (when staying with entry/exit delay on)

To arm your system's perimeter protection and stay (interior protection not armed), enter your user code and press the **STAY [3]** key. The keypad will beep 3 times and **STAY** will be displayed. *You may move about within the premises, but if the entry/exit delay door is opened after the exit delay has expired, an alarm will occur unless the system is disarmed during the entry delay period.*

INSTANT ARMING (with exit delay only)

The **INSTANT** mode is used primarily in residences and provides perimeter protection with entry delay off. It is usually used during sleeping hours (when entry delay is not desirable).

To arm in **INSTANT** mode, enter your user code and press the **INSTANT [7]** key. The keypad will beep three times and both **STAY** and **INSTANT** will be displayed. *After the "exit" delay, an entry will cause an **INSTANT** alarm.*

MAXIMUM ARMING (with exit delay only)

MAXIMUM mode arms both interior and perimeter protection with entry delay off, and is suggested for use when the premises will be empty for extended periods of time (ex. holiday, or for first floor protection during the sleeping period if your sleeping quarters are on the second floor.).

To arm in the **MAXIMUM** mode, enter your user code and press the **MAXIMUM [4]** key. The keypad will beep twice and both **AWAY** and **INSTANT** will be displayed. *After the exit delay, ANY disturbance of the protection (perimeter or interior) will cause an **INSTANT** alarm, including entry through the delay door.*

BYPASSING ZONES

Zones of protection can be bypassed prior to arming, as follows:

1. Enter your user code.
2. Press the **BYPASS [6]** key.

3. Press the zone number to be bypassed. Enter it as 2 digits (if less than 10, press [0] + zone number).

The console will display the word **BYPASS** and each zone number bypassed, accompanied by a beep for each.

Note: Fire zones cannot be bypassed.

CHIME MODE

If, while the system is disarmed, you wish the keypad to beep if any part of the perimeter protection is opened (ex. door or window), enter your user code and press the CHIME [9] key. CHIME will be displayed. To turn the CHIME mode off, repeat the entry sequence.

TEST MODE (Use weekly to test your alarm system)

See "TESTING THE SYSTEM" section later in this manual.

USING THE KEYSWITCH (if installed)

A single light is used to indicate the status of your system.

LIGHT OFF = System is not ready for arming.

SLOW FLASH = System is ready for arming.

To arm in the AWAY mode, turn key to right for 1/2 second.

To arm in the STAY mode, hold key in right position for more than one second.

Consoles will beep twice (AWAY mode) or 3 times (STAY mode) depending on the arming mode and the keyswitch light will flash rapidly.

To disarm the system, turn the key to the right.

If an alarm has occurred during the armed time, the alarm can be silenced by a single operation of the keyswitch, but the light will not flash. Refer to the console to diagnose and clear the problem. A second operation of the keyswitch can also clear the alarm memory mode (see the next page).

ASSIGNING SECONDARY USER CODES

Assigning or changing secondary user codes from the keypad can be done as follows, by a person knowing the master code:

1. Enter your master code.
2. Press the CODE [8] key.
3. Enter user number 2, 3, 4, 5, 6, or 7.
4. Enter a 4-digit code for that user.

For greater security, avoid "simple" secondary codes, such as: 1111 or 1234.

Example: To assign a code of 2463 to user 3 (master code 1367), enter:

[1] + [3] + [6] + [7] + [CODE] + [3] + [2] + [4] + [6] + [3]

If the entry is properly keyed, the keypad will beep once after the entry is completed.

To delete a previously entered code, perform steps 1, 2 & 3 above. The system will delete that user's code if no code is entered (skip step 4).

* **DURESS OPTION**

This feature is intended for use when you are forced to disarm or arm the system under threat. When used, the system will act normally, but can silently notify the central station of your situation, if that service has been provided.

The Duress code may be any 4-digit code assigned to User Number 8.

To program a Duress code:

Enter your Master Code + [8] + [8] + [desired 4-digit duress code].
The keypad will beep once.

Note: The Duress code must differ from the Master Code or any other User's Code.

To change the Duress code, Enter Master Code + [8] + [8] + [new 4-digit duress code].

To delete the Duress code, Enter your Master Code + [8] + [8], and then stop. When the keypad beeps once it signifies that the code has been deleted.

* Active if checked

CHANGING YOUR MASTER CODE

Enter your Master code + [8] + [1] + [new Master code] + [new Master code again].

The keypad will beep 3 times, indicating acceptance.

ALARM MEMORY

When an alarm condition occurs, the console display will indicate the number(s) of the zone(s) that were violated, and will display the type of alarm (ex. FIRE and ALARM, or ALARM).

The alarm display will remain on until the user code + OFF [1] key sequence is entered twice (or an optional keyswitch is operated twice). If you return and enter the premises after the main alarm sounder has shut itself off, the keypad will also beep rapidly as soon as you enter through the delay zone, to alert you to the alarm. If this occurs, leave immediately and contact the police from a nearby safe location. If you return and the main alarm sounder is on, DO NOT enter the premises, but call the police from a nearby safe location.

Silencing Fire Alarm Sound: Pressing the OFF key turns off the sound for a fire alarm. No code entry is required. The alarm remains in memory, however, until your 4-digit user code + OFF [1] key sequence is entered.

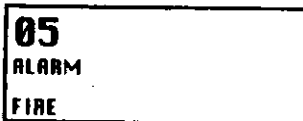

CONSOLE DISPLAY
for
"FIRE ALARM, ZONE 5"

KEYPAD INITIATED ALARMS (Panic Keys)

The following special keypad initiated alarms refer to 24 hour options that apply to your system *only* for those boxes (and line) checked by your installer.

* Emergency/Fire Option

Panic alarms, as checked, can be produced by pressing a pair of keys at the same time:

<u>KEYS</u>	<u>FUNCTION</u>
<input type="checkbox"/> [*] & [#]	___Silent, ___Audible, ___Personal, ___Fire
<input type="checkbox"/> [1] & [*]	Silent Emergency
<input type="checkbox"/> [3] & [#]	Full Audible Emergency (main alarm & keypad)

* Active if checked

TESTING THE SYSTEM (test weekly)

The test mode allows each protection point to be checked for proper operation. A test should be conducted weekly, as follows:

Note: No alarm reports will be sent to the central monitoring station when the system is in the test mode.

1. Disarm the system and close all protected windows, doors, etc. **READY** should be displayed on the console.
2. While **READY** is displayed, enter your user code and press the TEST [5] key to enter the test mode.
3. The console will sound a single beep every 40 seconds as a reminder that the system is in the test mode. Each time a protection zone is faulted, the external siren should sound for one second and then turn off. If this does not happen, call for service immediately.
4. Open and close each protected door and window in turn and listen for the required sound.
5. Walk in front of any interior motion detectors (if used) and listen for the required sound as movement is detected.
6. Follow the test procedure provided by the manufacturer of each smoke detector to ensure that all detectors are operational and functioning properly.
7. Turn off the test mode by entering your user code and pressing the OFF [1] key.

TROUBLE CONDITIONS

"BAT" (BATTERY) Display

A display of **BAT** with no zone number indicates that the main standby battery in your control is weak. If this condition persists for more than one day (with AC mains present), call for service.

If the **BAT** display appears *with* a zone number, it indicates that there are wireless transmitters in your system and the battery in that zone's transmitter is getting low. If the battery is not replaced within 30 days, a **CHECK** display (see below) may occur.

"CHECK" Conditions

A console display of **CHECK** and a zone number indicates a condition that requires your attention. If the **CHECK** display relates to a fire zone, call for service immediately. If the **CHECK** display relates to a burglary zone, a zone has been violated during the disarmed state that should not normally be violated. The display is accompanied by rapid beeping from the keypad, and it can be silenced by pressing any key on the console.

If there are wireless transmitters in your system, the **CHECK** condition may also be caused by some change in the environment that prevents the receiver from receiving signals from a particular transmitter. Consult your service company if this occurs.

The display will not turn off until the zone is restored by you (or by a service person if the problem cannot be resolved by you). To clear the display after the zones have been restored, enter the OFF sequence (user code + OFF key) twice.

Power Failure Indications

If the **POWER** indicator is off and **NO AC** is displayed, AC mains power is absent, but the system is operating from its back-up battery.

If the **POWER** indicator is off and there is no display at all, ALL power is off *and the system is inoperative*. **CALL FOR SERVICE IMMEDIATELY.**

Other Displays

"dl": If this remains displayed for more than 1 minute, your system is disabled. Call for service immediately.

NOTE: *If either of the following remain displayed for more than ten minutes, call your service company.*

"cc": System is in communication with the central station for change of function or status verification.

"oc": Console or system is inoperative and sees an "open circuit".

EMERGENCY EVACUATION

Establish and regularly practice a plan of escape in the event of fire.

1. Plan on your detector or your interior and/or exterior sounders warning all occupants.
2. Determine two means of escape from each room. One path of escape should lead to the door that permits normal exit from the building. The other may be a window, should your path be unpassable. Station an escape ladder at such windows if there is a long drop to the ground.
3. Sketch a floor plan of the building. Show windows, doors, stairs and rooftops that can be used to escape. Indicate escape routes for each room. Keep these routes free from obstruction and post copies of the escape routes in every room.
4. Assure that all bedroom doors are shut while you are asleep. This will prevent deadly smoke from entering while you escape.
5. If the door is hot, check your alternate escape route. If the door is cool, open it cautiously. Be prepared to slam the door if smoke or heat rushes in.
6. Crawl in the smoke and hold your breath.
7. Escape quickly; don't panic.
8. Establish a common meeting place outdoors, away from your house, where everyone can meet and then take steps to contact the authorities and account for those missing. Choose someone to assure that nobody returns to the house — many die going back.

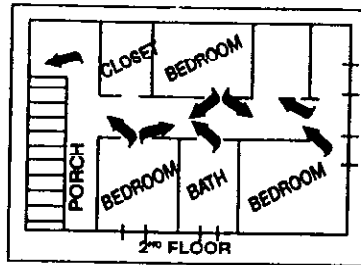
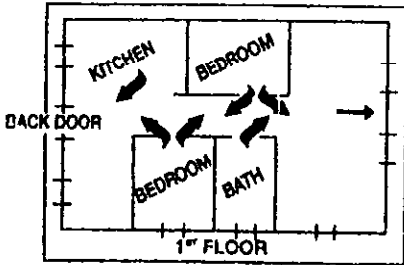
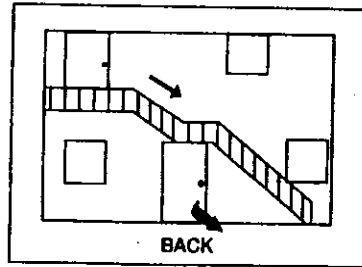
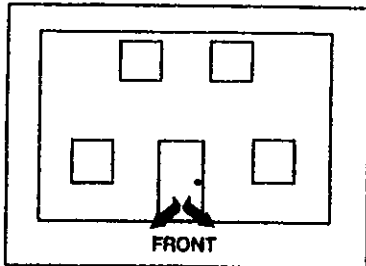

WARNING

THE LIMITATIONS OF THIS ALARM SYSTEM

While this System is an advanced design security system, it does not offer guaranteed protection against burglary, fire or other emergency. Any alarm system, whether commercial or residential, is subject to compromise or failure to warn for a variety of reasons. For example:

- Intruders may gain access through unprotected openings or have the technical sophistication to bypass an alarm sensor or disconnect an alarm warning device.
- Intrusion detectors (e.g., passive infrared detectors), smoke detectors, and many other sensing devices will not work without power. Battery-operated devices will not work without batteries, with dead batteries, or if the batteries are not put in properly. Devices powered solely by AC will not work if their AC power supply is cut off for any reason, however briefly.
- Signals sent by wireless transmitters may be blocked or reflected by metal before they reach the alarm receiver. Even if the signal path has been recently checked during a weekly test, blockage can occur if a metal object is moved into the path.
- A user may not be able to reach a panic or emergency button quickly enough.
- While smoke detectors have played a key role in reducing residential fire deaths, they may not activate or provide early warning for a variety of reasons in as many as 35% of all fires. Some of the reasons smoke detectors used in conjunction with this System may not work are as follows. Smoke detectors may have been improperly installed and positioned. Smoke detectors may not sense fires that start where smoke cannot reach the detectors, such as in chimneys, in walls, or roofs, or on the other side of closed doors. Smoke detectors also may not sense a fire on another level of a residence or building. A second floor detector, for example, may not sense a first floor or basement fire. Finally, smoke detectors have sensing limitations. No smoke detector can sense every kind of fire every time. In general, detectors may not always warn about fires caused by carelessness and safety hazards like smoking in bed, violent explosions, escaping gas, improper storage of flammable materials, overloaded electrical circuits, children playing with matches, or arson. Depending on the nature of the fire and/or location of the smoke detectors, the detector, even if it operates as anticipated, may not provide sufficient warning to allow all occupants to escape in time to prevent injury or death.
- Passive Infrared Motion Detectors can only detect intrusion within the designed ranges as diagrammed in their installation manual. Passive Infrared Detectors do not provide volumetric area protection. They do create multiple beams of protection, and intrusion can only be detected in unobstructed areas covered by those beams. They cannot detect motion or intrusion that takes place behind walls, ceilings, floors, closed doors, glass partitions, glass doors, or windows.

Mechanical tampering, masking, painting or spraying of any material on the mirrors, windows or any part of the optical system can reduce their detection ability. Passive Infrared Detectors sense changes in temperature; however, as the ambient temperature of the protected area approaches the temperature range of 32° to 40°C, the detection performance can decrease.

- Alarm warning devices such as sirens, bells or horns may not alert people or wake up sleepers if they are located on the other side of closed or partly open doors. If warning devices are located on a different level of the residence from the bedrooms, then they are less likely to waken or alert people inside the bedrooms. Even persons who are awake may not hear the warning if the alarm is muffled by noise from a stereo, radio, air conditioner or other appliance, or by passing traffic. Finally, alarm warning devices, however loud, may not warn hearing-impaired people.
- Telephone lines needed to transmit alarm signals from a premises to a central monitoring station may be out of service or temporarily out of service. Telephone lines are also subject to compromise by sophisticated intruders.
- Even if the system responds to the emergency as intended, however, occupants may have insufficient time to protect themselves from the emergency situation. In the case of a monitored alarm system, authorities may not respond appropriately.
- This equipment, like other electrical devices, is subject to component failure. Even though this equipment is designed to last as long as 20 years, the electronic components could fail at any time.

The most common cause of an alarm system not functioning when an intrusion or fire occurs is inadequate maintenance. This alarm system should be tested weekly to make sure all sensors and transmitters are working properly. The security console (and remote keypad) should be tested as well.

Wireless transmitters (used with some systems) are designed to provide long battery life under normal operating conditions. Longevity of batteries may be as much as 4 to 7 years, depending on the environment, usage, and the specific wireless device being used. External factors such as humidity, high or low temperatures, as well as large swings in temperature, may all reduce the actual battery life in a given installation. The system, however, can identify a true low battery situation, thus allowing time to arrange a change of battery to maintain protection for that given point within the system.

Installing an alarm system may make the owner eligible for a lower insurance rate, but an alarm system is not a substitute for insurance. Homeowners, property owners and renters should continue to act prudently in protecting themselves and continue to insure their lives and property.

We continue to develop new and improved protection devices. Users of alarm systems owe it to themselves and their loved ones to learn about these developments.

ADEMCO ONE YEAR LIMITED WARRANTY

Alarm Device Manufacturing Company, a Division of Pittway Corporation, and its divisions, subsidiaries and affiliates ("Seller"), 165 Eileen Way, Syosset, New York 11791, warrants its security equipment (the "product") to be free from defects in materials and workmanship for one year from date of original purchase, under normal use and service. Seller's obligation is limited to repairing or replacing, at its option, free of charge for parts, labor, or transportation, any product proven to be defective in materials or workmanship under normal use and service. Seller shall have no obligation under this warranty or otherwise if the product is altered or improperly repaired or serviced by anyone other than the Seller. In case of defect, contact the security professional who installed and maintains your security equipment or the Seller for product repair.

This one year Limited Warranty is in lieu of all other express warranties, obligations or liabilities. THERE ARE NO EXPRESS WARRANTIES, WHICH EXTEND BEYOND THE FACE HEREOF. ANY IMPLIED WARRANTIES, OBLIGATIONS OR LIABILITIES MADE BY SELLER IN CONNECTION WITH THIS PRODUCT, INCLUDING ANY IMPLIED WARRANTY OF MERCHANTABILITY, OR FITNESS FOR A PARTICULAR PURPOSE OR OTHERWISE, ARE LIMITED IN DURATION TO A PERIOD OF ONE YEAR FROM THE DATE OF ORIGINAL PURCHASE. ANY ACTION FOR BREACH OF ANY WARRANTY, INCLUDING BUT NOT LIMITED TO ANY IMPLIED WARRANTY OF MERCHANTABILITY, MUST BE BROUGHT WITHIN 12 MONTHS FROM DATE OF ORIGINAL PURCHASE. IN NO CASE SHALL SELLER BE LIABLE TO ANYONE FOR ANY CONSEQUENTIAL OR INCIDENTAL DAMAGES FOR BREACH OF THIS OR ANY OTHER WARRANTY, EXPRESS OR IMPLIED, OR UPON ANY OTHER BASIS OF LIABILITY WHATSOEVER, EVEN IF THE LOSS OR DAMAGE IS CAUSED BY THE SELLER'S OWN NEGLIGENCE OR FAULT. Some states do not allow limitation on how long an implied warranty lasts or the exclusion or limitation of incidental or consequential damages, so the above limitation or exclusion may not apply to you.

Seller does not represent that the product may not be compromised or circumvented; that the product will prevent any personal injury or property loss by burglary, robbery, fire or otherwise; or that the product will in all cases provide adequate warning or protection. Buyer understands that a properly installed and maintained alarm may only reduce the risk of a burglary, robbery, fire or other events occurring without providing an alarm, but it is not insurance or a guarantee that such will not occur or that there will be no personal injury or property loss as a result. CONSEQUENTLY, SELLER SHALL HAVE NO LIABILITY FOR ANY PERSONAL INJURY, PROPERTY DAMAGE OR OTHER LOSS BASED ON A CLAIM THE PRODUCT FAILED TO GIVE WARNING. HOWEVER, IF SELLER IS HELD LIABLE, WHETHER DIRECTLY OR INDIRECTLY, FOR ANY LOSS OR DAMAGE ARISING UNDER THIS LIMITED WARRANTY OR OTHERWISE, REGARDLESS OF CAUSE OR ORIGIN, SELLER'S MAXIMUM LIABILITY SHALL NOT IN ANY CASE EXCEED THE PURCHASE PRICE OF THE PRODUCT, WHICH SHALL BE THE COMPLETE AND EXCLUSIVE REMEDY AGAINST SELLER. This warranty gives you specific legal rights, and you may also have other rights which vary from state to state. No increase or alteration, written or verbal, to this warranty is authorized.

YOUR SERVICE COMPANY

Name: _____ Telephone: _____

Address: _____
